

Don't just visit Alaska, experience it!

# Alaska

## TRAVEL ADVENTURES



**EXPLORE ALASKA WITH US:**



### **ALASKA HIGHWAY CRUISES®**

Combined RV and Cruise Vacations P. 2-7



### **ALASKA MOTORHOME RENTALS®**

Independent RV Rentals P. 8-9



### **TOURS & ATTRACTIONS**

Guided Soft Adventures P. 10-13





# 2022 RATES: COMBINED RV AND CRUISE VACATIONS

Prices effective through 10/15/2020. Rates subject to change. Taxes are not included in prices.

## TOUR 1: GOLD RUSH MEMORIES

DEPARTURE DATE	SHIP	PPDO
May 27	VO	\$2,699
June 3	VO	\$2,799
June 10; Aug. 19	VO	\$2,899
June 17; Aug. 12	VO	\$2,999
July 29; Aug. 5	VO	\$3,099
June 24; July 22	VO	\$3,199
July 1, 8, 15	VO	\$3,299

VO=MS VOLENDAM; 3rd/4th Adult Share \$529; 3rd/4th Child Share (up to age 18) \$449; Gov't Fees & Taxes: \$129 ppdo; \$84 3rd/4th; Drivers Insurance: \$75 Per Driver; Cancellation Fees Protection: 10% of Total Price; Per Person, Double Occupancy (PPDO) prices are based on Ocean View Stateroom Category FF.

## TOUR 2: KLONDIKE FEVER

DEPARTURE DATE	SHIP	PPDO
May 24	VO	\$2,799
May 31	VO	\$2,899
June 7; Aug. 16	VO	\$2,999
June 14; Aug. 9	VO	\$3,099
July 26; Aug. 2	VO	\$3,199
June 21; July 19	VO	\$3,299
June 28; July 5, 12	VO	\$3,399

VO=MS VOLENDAM; 3rd/4th Adult Share \$659; 3rd/4th Child Share (up to age 18) \$559; Gov't Fees & Taxes: \$219 ppdo; \$112 3rd/4th; Drivers Insurance: \$75 Per Driver; Cancellation Fees Protection: 10% of Total Price; Per Person, Double Occupancy (PPDO) prices are based on Ocean View Stateroom Category FF.

## TOUR 3/3-R | 3-K/3-KR: NORTHERN HIGHLIGHTS

DEPARTURE DATE	SHIP	PPDO
May 8 (3 ONLY); 15, 22, 29;		
Sept. 4 (3R ONLY)	NA/NO	\$2,499
Aug. 28	NA	\$2,599
Aug. 14, 21	NA/NO	\$2,699
June 5	NA	\$2,899
Aug. 7	NO	\$2,999
June 12, 19, 26;		
July 3, 10, 17, 24, 31	NA/NO	\$3,399

3rd/4th Adult Share \$929; 3rd/4th Child Share (up to age 18) \$789.  
**NA=NIEUW AMSTERDAM:** [3/3K] Gov't Fees & Taxes: \$320 ppdo; \$232 3rd/4th. [3R/3KR] Gov't Fees & Taxes: \$383 ppdo; \$258 3rd/4th.  
**NO=NOORDAM:** [3/3K] Gov't Fees & Taxes: \$322 ppdo; \$234 3rd/4th. [3R/3KR] Gov't Fees & Taxes: \$376 ppdo; \$251 3rd/4th. Drivers Insurance: \$75 Per Driver. Cancellation Fees Protection: 5% of Total Price. Per Person, Double Occupancy (PPDO) prices are based on Interior Stateroom Category J.

Visit [AlaskaTravelAdventures.com](http://AlaskaTravelAdventures.com) for cruise ship photos & details, and special offers.

## TOUR 4: ALASKA HIGHWAYS ADVENTURE

DEPARTURE DATE	SHIP	PPDO
May 8, 15	NA/NO	\$3,599
May 22; Aug. 28	NA	\$3,699
Aug. 14, 21	NA/NO	\$3,799
May 29	NO	\$3,999
Aug. 7	NO	\$4,099
July 31	NA	\$4,599
June 5	NA	\$4,699
June 12	NO	\$4,999
June 19, 26; July 3, 10, 17, 24	NA/NO	\$5,099

## TOUR 4-R: (Reverse)

DEPARTURE DATE	SHIP	PPDO
May 15, 22; Aug. 21, 28	NA/NO	\$3,799
May 29; Aug. 14	NA/NO	\$3,999
June 5	NO	\$4,299
Aug. 7	NA	\$4,499
June 12	NA	\$4,999
June 19, 26;		
July 3, 10, 17, 24, 31	NA/NO	\$5,199

## TOUR 4-E: (Extended)

DEPARTURE DATE	SHIP	PPDO
May 8	NA	\$4,299
May 15	NO	\$4,399
May 22; Aug. 28	NA	\$4,899
Aug. 14, 21	NA/NO	\$4,999
July 31; Aug. 7	NA/NO	\$5,099
May 29	NO	\$5,399
July 24	NO	\$5,599
June 5, 12	NA/NO	\$5,799
July 17	NA	\$5,999
June 19, 26	NA/NO	\$6,099
July 3, 10	NA/NO	\$6,299

## TOUR 4-ER: (Extended-Reverse)

DEPARTURE DATE	SHIP	PPDO
May 8, 15	NA/NO	\$4,499
Aug. 7, 14	NA/NO	\$4,599
May 22	NA	\$4,899
July 31	NA	\$5,199
May 29	NO	\$5,599
July 3, 17	NA	\$5,899
July 24	NO	\$5,999
June 5, 19; July 10	NA/NO	\$6,099
June 26	NO	\$6,199
June 12	NO	\$6,399

## TOUR 5: NATIONAL PARKS EXPLORER

DEPARTURE DATE	SHIP	PPDO
May 8, 15, 22	NA/NO	\$3,199
Aug. 14, 21	NA/NO	\$3,399
May 29	NO	\$3,499
Aug. 7	NO	\$3,599
June 5; July 31	NA	\$4,099
June 12	NO	\$4,299
June 19, 26; July 3, 10, 17, 24	NA/NO	\$4,399

## TOUR 5-R: (Reverse)

DEPARTURE DATE	SHIP	PPDO
May 15, 22; Aug. 21, 28	NA/NO	\$3,399
May 29	NA	\$3,499
Aug. 14	NO	\$3,599
June 5	NO	\$3,699
Aug. 7	NA	\$3,899
June 12	NA	\$4,299
June 19, 26;		
July 3, 10, 17, 24, 31	NA/NO	\$4,499

3rd/4th Adult Share \$929; 3rd/4th Child Share (up to age 18) \$789. **NA=NIEUW AMSTERDAM:** [4] Gov't Fees & Taxes: \$391 ppdo; \$232 3rd/4th. [4R] Gov't Fees & Taxes: \$258 ppdo; \$258 3rd/4th. [4E] Gov't Fees & Taxes: \$517 ppdo; \$232 3rd/4th. [4ER] Gov't Fees & Taxes: \$258 ppdo; \$258 3rd/4th. **NO=NOORDAM:** [4] Gov't Fees & Taxes: \$392 ppdo; \$234 3rd/4th. [4R] Gov't Fees & Taxes: \$251 ppdo; \$251 3rd/4th. [4E] Gov't Fees & Taxes: \$518 ppdo; \$234 3rd/4th. [4ER] Gov't Fees & Taxes: \$251 ppdo; \$251 3rd/4th. Drivers Insurance: \$85 Per Driver. Cancellation Fees Protection: 10% of Total Price. Per Person, Double Occupancy (PPDO) prices are based on Interior Stateroom Category J.

3rd/4th Adult Share \$929; 3rd/4th Child Share (up to age 18) \$789. **NA=NIEUW AMSTERDAM:** [5] Gov't Fees & Taxes: \$414 ppdo; \$232 3rd/4th. [5R] Gov't Fees & Taxes: \$440 ppdo; \$258 3rd/4th. **NO=NOORDAM:** [5] Gov't Fees & Taxes: \$416 ppdo; \$234 3rd/4th. [5R] Gov't Fees & Taxes: \$433 ppdo; \$251 3rd/4th. Drivers Insurance: \$85 Per Driver. Cancellation Fees Protection: 10% of Total Price. Per Person, Double Occupancy (PPDO) prices are based on Interior Stateroom Category J.





## 2022 RATES: TOURS & ATTRACTIONS

TOUR RATES	ADULT	CHILD
<b>JUNEAU</b>		
Best of Juneau*	\$219	\$167
Glacier View Sea Kayaking	\$124	\$93
Gold Creek Salmon Bake	\$62	\$46
Historic Gold Mining & Panning Adventure	\$79	\$60
Historic Gold Mining & Salmon Bake	\$109	\$82
Mendenhall Glacier Float Trip	\$165	\$124
Mendenhall Glacier & Salmon Bake	\$129	\$97
Mendenhall Lake Canoe Adventure	\$209	\$159
Mendenhall Lake Kayak Adventure	\$229	\$169
Mendenhall Lake Kayak & Salmon Bake	\$259	\$194
Whale Watching Adventure	\$129	\$97
Whale Watching & Salmon Bake	\$179	\$135
<b>KETCHIKAN</b>		
Backcountry Jeep® & Canoe Safari	\$179	\$134
Rainforest Canoe Adventure & Nature Trail	\$119	\$89
Rainforest Island Adventure	\$159	\$119
Totem Bight State Historical Park & Rainforest Canoe Adventure	\$159	\$119
<b>SITKA</b>		
Wilderness Sea Kayaking Adventure	\$174	\$131
<b>SKAGWAY</b>		
Skagway Salmon Bake at Liarsville	\$54	\$41
Liarsville Gold Rush Trail Camp & Salmon Bake	\$69	\$52

*Taxes are not included on the above prices. Child rate applies to ages 12 & under. Complete descriptions and requirements are available at [AlaskaTravelAdventures.com](https://AlaskaTravelAdventures.com).*

## 2022 RATES: ANCHORAGE RV PARK

DATES	5/1 - 9/30
Water, Sewer & Electric	\$59
Pull Through Water, Sewer & Electric	\$69
Dry Sites & Tent Sites	\$39

## 2022 RATES: RV RENTALS

RATES PER DAY	4 - 6 DAYS	7 - 20 DAYS	21+ DAYS
<b>MAY 1 - JUNE 14</b>			
Standard Class C Motorhome	\$199	\$179	\$169
Large Class C Motorhome	\$219	\$199	\$189
<b>JUNE 15 - AUG. 15</b>			
Standard Class C Motorhome	\$349	\$319	\$309
Large Class C Motorhome	\$369	\$339	\$329
<b>AUG. 16 - SEPT. 30</b>			
Standard Class C Motorhome	\$199	\$179	\$169
Large Class C Motorhome	\$219	\$199	\$189

*One Way Rental rates available online. Applicable taxes not included. Rates shown above are in U.S. funds and on a per day basis. Per day rates reflect the number of nights that the motorhome is in the possession of the customer. If the unlimited mileage option is not purchased, mileage is charged at the rate of \$.39 per mile plus applicable tax. For the unlimited mileage option add \$39 per night to the rate tables above, plus applicable tax. Airport/Hotel transfers are available for \$49 each way.*

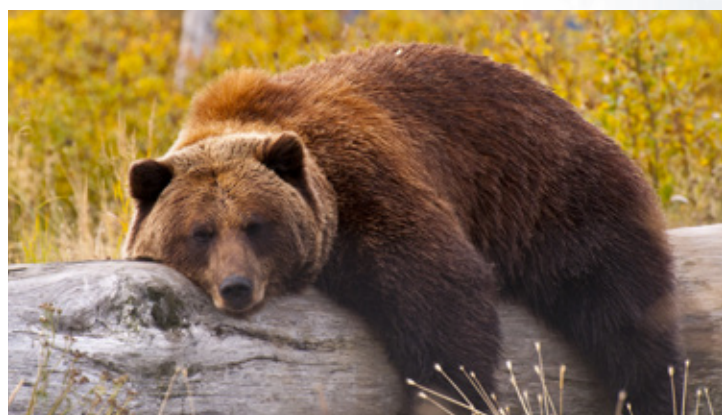



## GREETINGS FROM ALASKA!

Nicknamed “The Last Frontier”, there are few places on earth that capture the imagination like Alaska. Within rugged mountains, dense rainforests, and breathtaking glaciers lies a rich history, abundant wildlife, and an undeniably Alaskan spirit of adventure. For many, it’s the destination of a lifetime.

Whether your Alaska vacation dreams involve a luxury cruise, an independent highway adventure, or a combination of land and sea travel, Alaska Travel Adventures can help you make your time in Alaska truly unforgettable. Founded in 1978, we are one of Alaska’s most experienced and most diversified vacation companies. With operations in 5 of the most popular Alaska travel destinations, we offer a time-tested selection of expertly guided day tours, attractions, and travel packages.

For fans of “choose your own adventure” stories and lovers of the open road, there’s no better way to explore Alaska’s interior than from the comfort and convenience of an RV. Sitting up high to better enjoy the scenery; you have total freedom to stop when and where you want, for however long you wish. Most of our [Alaska Motorhome Rentals](#) customers tell us that they wouldn’t do it any other way.

For those seeking a best of both worlds—combination of adventure and luxury, our [Alaska Highway Cruises](#) RV and cruise packages can’t be beat. This complete land and sea vacation package combines a 3, 4 or 7-day Holland America Line cruise together with 1 to 3 weeks exploring Alaska in your own private, easy-to-drive Class C motorhome. Packages include a reserved private campground, easy-to-follow maps and directions, and the freedom to set your own pace.

Whether traveling on land or by sea, our [Alaska Travel Adventures Tours & Attractions](#) can help you make the most of your vacation with unique Alaskan experiences. We offer a variety of guided tours designed to suit a wide range of ages and abilities. Drive your own 4-wheel drive Jeep Wrangler on mountain roads through Ketchikan’s lush rainforest, commune with nature on a whale watching cruise or on a nature hike through a temperate rainforest. Experience whitewater rafting on a glacier-fed river, sea kayaking in a peaceful bay, or paddle an authentic Alaska Native style canoe among icebergs at a glacier face. Many tours and attractions can even be combined; for example, try your luck at gold panning and then taste wild Alaska salmon at one of our real outdoor salmon bakes. All of these activities and more are available throughout Alaska; see inside this brochure for details and visit [AlaskaTravelAdventures.com](#) for videos and additional photos and information.

Thank you for your interest in [Alaska Travel Adventures](#). Please call, and let us help make your Alaska dreams come true.

Sincerely,

*Chris Meier*  
Chris Meier, President

## MAKING ALASKA VACATION DREAMS COME TRUE SINCE 1978!

### ALASKA HIGHWAY CRUISES®

Combined RV and Cruise Vacations . . . . .	2
Gold Rush Memories . . . . .	3
Klondike Fever . . . . .	4
Northern Highlights . . . . .	5
Alaska Highway Adventures . . . . .	6
National Parks Explorer . . . . .	7

### ALASKA MOTORHOME RENTALS®

The Ultimate Road Adventure . . . . .	8
RV Floorplans & FAQs . . . . .	9

### TOURS & ATTRACTIONS

*Late April through early October*

Tours & Attractions in Juneau . . . . .	10-11
Tours & Attractions in Ketchikan . . . . .	12
Tours & Attractions in Sitka & Skagway . . . . .	13

### ANCHORAGE RV PARK

Ship Creek RV Park . . . . .	14
------------------------------	----



[AlaskaTravelAdventures.com](#)

1-800-323-5757 • [info@AlaskaTravelAdventures.com](mailto:info@AlaskaTravelAdventures.com)

Alaska Travel Adventures strives to accommodate people with disabilities.  
We are committed to protecting the environment and reducing  
our contribution to global climate change.





# ALASKA'S ONLY COMBINED RV AND CRUISE VACATION!

Every **Alaska Highway Cruises** vacation includes a **Holland America Line** cruise along with an up-close and personal experience in your own RV. You have several choices of cruise itinerary; all include the incredibly scenic Inside Passage. Whether you cruise before or after your land tour, you'll find each experience makes the other more meaningful. Only when you view this tremendous state from both land and sea can you fully comprehend and appreciate its immensity, its diversity and its magnificent beauty.

**Why we're different.** We are the only operator of combined cruise and motorhome vacations in Alaska and our goal is to provide you a fulfilling, adventure-packed Alaska experience. Planning your dream Alaska vacation can be overwhelming, with a land area of over 586,000 square miles, and east to west borders spanning 2,400 miles, there are countless adventures to choose from. With nearly 40 years of expertise in Alaska tourism, we are here to help make those choices a little easier.

A luxury cruise to Alaska is the choice of many visitors to best enjoy the magnificent scenery and discover the awe of cruising silently through the untouched wilderness of the famed Inside Passage. Watch for the telltale spout of a humpback whale, visit the colorful ports of call in Southeast Alaska and may have the chance to experience the roar of calving glaciers in Glacier Bay National Park. All these amazing experiences while being pampered aboard a ship with sumptuous dining, live entertainment and many more incredible amenities of these floating resorts!

However, to limit your Alaska vacation to only experiencing this vast and extraordinary state by sea, is to miss the opportunity to truly discover the untamed wilderness and diverse culture that makes Alaska a dream destination for so many. Visitors that combine a land and sea adventure for their Alaska vacation are able to truly experience the best that Alaska has to offer.

Treating visitors to the best of Alaska by both land and sea is what **Alaska Highway Cruises** is all about. Many visitors view Alaska's interior from the confines of a large motorcoach or railcar, we offer our customers the convenience, freedom and flexibility of a fully equipped, late model Class C motorhome, allowing them to choose where to go and when.

**Sail with the World's Best Cruise Line.** Holland America Line boasts Alaska's largest 5-star fleet—consistently voted “best cruise value” by those who know cruising best. That is why it is our choice for the cruise portion of your **Alaska Highway Cruises** vacation.

**The Inside Passage.** This thousand-mile waterway is a magical world of narrow passageways, forests, mountains and deep fjords. As you sail silently through this untamed and enchanting land, keep an eye out for whales, eagles and countless other animals that call these lands home.

**Ketchikan.** Come ashore to one of the state's most picturesque communities. Fishing boats, pleasure craft and planes shelter in the harbor. Shore excursion options may include the **Backcountry Jeep & Canoe Safari**, **Rainforest Island Adventure**, or **Rainforest Canoe & Nature Trail**—combine with **Totem Bight State Historical Park** or browse the Creek Street boutiques and waterfront shops.

**Juneau.** Accessible only by boat or plane, pivotal in Gold Rush history, summer feeding grounds of Humpback and Orca whales and home to one of the only road accessible Glaciers in Alaska, there is so much to discover in Alaska's Capital. Experience the **Best of Juneau\***, which will take you to the famous Mendenhall Glacier, **Whale Watching Adventure**, and the original **Alaska Salmon Bake**. We have a host of other tour options as well; **Glacier Float Trip**, **Glacier View Sea Kayaking**, **Historic Gold Mining & Panning**, **Mendenhall Glacier Lake Canoe or Kayaking**, and more.

**Skagway.** The sidewalks are all but rolled up in Skagway come winter, so you can only imagine the frightful conditions endured by the gold prospectors who passed through enroute to the Yukon, with a mandatory ton of supplies to be hauled with them over the steep and treacherous Trail of '98. 21st-century summertime visits to Skagway require nothing of the sort, but you're sure to enjoy the history, entertainment and the mouth-watering grilled salmon at **Liamsville Gold Rush Trail Camp & Salmon Bake**, a replica 1890s community so named for the tall-tales published by journalists assigned to cover the Klondike Gold Rush.

**Alaska's Interior.** Exploring Alaska's interior is the best way to experience Alaska's wide open spaces, witness the splendor of Denali in Denali National Park. View wildlife such as moose, brown bears, foxes and caribou in their natural habitat or participate in one of Alaska's favorite pastimes and cast a line for salmon or trout in one of Alaska's 3,000 rivers.

**The freedom of an RV.** What advantages does RV travel provide? It means there are no long lines associated with traveling in a large group. No daily packing and unpacking luggage and no rigid schedules to follow. Stop for that special photo opportunity or to have lunch, wherever and whenever you please. Your reserved campsites mean peace of mind and no rush to reach your next exciting destination.

**The ease of an RV.** Never driven a motorhome before? No problem. Most of our guests are first time RVers, and they say it's as easy as driving a car. We provide all the orientation you need to make sure your motorhome journey is carefree and provide you with a toll-free number to call us in the event you have any questions along the way. See for yourself why thousands of our past customers tell us if they had an opportunity to visit Alaska again, they wouldn't do it any other way.

.....  
Visit **AlaskaTravelAdventures.com** for customer reviews, specials and cruise ship upgrade supplements. *Complete terms and conditions available online.*  
.....

# TOUR 1: GOLD RUSH MEMORIES

3-NIGHT VANCOUVER TO SKAGWAY, INSIDE PASSAGE CRUISE INCLUDING TRACY ARM AND TWIN SAWYER GLACIERS PLUS THE YUKON, DENALI, FAIRBANKS & ANCHORAGE.

DAY	ITINERARY
1	Set sail from Vancouver, BC
2	Cruising the Inside Passage
3	Tracy Arm & Sawyer Glaciers (conditions permitting) Juneau, Alaska port call
4	Disembark in Skagway, Alaska
5	Whitehorse, Yukon
6	Beaver Creek, Yukon
7	Fairbanks, Alaska
8-9	Denali National Park
10-11	Anchorage, Alaska
12	Tour's End



**DAYS 1-3. CRUISING THE INSIDE PASSAGE. JUNEAU PORT OF CALL.** Board your cruise ship in Vancouver, B.C. and prepare for an unforgettable adventure. Cruise the beautiful Inside Passage including Tracy Arm and Twin Sawyer Glaciers enroute to Juneau, Alaska's capital. **Be sure and check out the variety of shore excursion options that are available.**

**DAY 4. SKAGWAY.** Pick up your motorhome at the Skagway RV depot and receive a thorough orientation. You'll have time to explore this historic town and stroll its boardwalks. Overnight in Skagway.

**DAY 5. SKAGWAY-WHITEHORSE.** Today you can seek out adventures in Skagway, including the optional **Liarsville Gold Rush Trail Camp & Salmon Bake**. Or just sleep late before beginning your motorhome tour with a drive up the scenic Klondike Highway to Whitehorse. You'll have an overview of the arduous White Pass Trail, used by stampedeers of the Klondike Gold Rush. In Whitehorse you overnight at your reserved campsite.

**DAY 6. WHITEHORSE-BEAVER CREEK.** Drive along blue, glacier-fed Kluane Lake, with the snowy peaks of the Kluane Ranges to the west. Take time for fishing, gold panning, hiking. Then arrive at Beaver Creek on the Yukon-Alaska border via the Alaska Highway. Overnight in Beaver Creek.

**DAY 7. BEAVER CREEK-FAIRBANKS.** Watch for the TransAlaska Pipeline as you continue on the Alaska Highway to Fairbanks. Summertime daylight lasts far into the night; in late summer you might see the Aurora Borealis. Overnight in Fairbanks.

**DAY 8. FAIRBANKS-DENALI.** While in Fairbanks, consider an optional riverboat cruise on the Discovery, a genuine sternwheeler, try gold panning at Gold Dredge #8, or visit the excellent museum at the University of Alaska. Then it's a shore drive south to your Denali area campground, where you'll spend two nights.

**DAY 9. DENALI NATIONAL PARK.** Denali National Park, home of North America's tallest mountain: 20,320-ft. Denali. Consider a flightseeing tour with a local naturalist to help you spot Dall sheep, moose and caribou in the peaks and valleys below.

**DAY 10. DENALI-ANCHORAGE.** Drive south on the Parks Highway, with mountain views to amaze you and friendly small towns along the way, such as Talkeetna—headquarters for Denali climbers. In Anchorage take in some city sights, or a great seafood dinner. Overnight at **Anchorage Ship Creek RV Park** for two nights.

**DAY 11. ANCHORAGE.** Free day in Anchorage. Recommended optional tours include the 26 Glacier Cruise or Kenai Fjords National Park tour. Overnight.

**DAY 12. ANCHORAGE, TOUR'S END.** This morning, drop off your RV, and we transfer you to the airport for your flight home, or on to your next adventure!

**CUSTOM SELECTION 1-A: Deletes Beaver Creek and second night in Anchorage. Adds Dawson City and Tok.** On day 6 drive Whitehorse to Dawson City and overnight. Day 7 drive Dawson City to Tok. On day 8 overnight Fairbanks, days 9 and 10 overnight Denali and day 11 overnight Anchorage.





# TOUR 2: KLONDIKE FEVER

ANCHORAGE, FAIRBANKS, DENALI & THE YUKON

PLUS 4-NIGHT SKAGWAY TO VANCOUVER INSIDE PASSAGE CRUISE INCLUDING GLACIER BAY.

DAY	ITINERARY
1	Anchorage to Denali
2	Denali National Park
3	Fairbanks, Alaska
4	Beaver Creek, Yukon
5	Whitehorse, Yukon
6	Skagway, Alaska
7	Set sail from Skagway, Alaska
8	Glacier Bay National Park
9	Ketchikan, Alaska port call
10	Cruise the Inside Passage
11	Vancouver, BC; Tour's End



**DAY 1. ANCHORAGE-DENALI.** We'll pick you up at the airport or a local hotel. After your orientation, strike out along the scenic Glenn and Parks Highways toward Denali National Park—six million acres of mountains, tundra, forests and rivers, and home of Denali, North America's tallest mountain. Overnight near Denali National Park for two nights.

**DAY 2. DENALI NATIONAL PARK.** Your free day to explore the Park. Optional local tours may be reserved ahead. Don't miss your opportunity to see Denali up close and personal.

**DAY 3. DENALI-FAIRBANKS.** Drive north to Fairbanks, the state's second-largest city. There's lots to see: the University of Alaska-Fairbanks and its fine museum and demonstration gardens; the TransAlaska Pipeline just out of town; the huge retired Gold Dredge #8, where you can try your luck at gold panning; an optional cruise on the sternwheeler Discovery. Overnight in Fairbanks.

**DAY 4. FAIRBANKS-BEAVER CREEK.** Head out on the Alaska Highway to Beaver Creek, near the Yukon-Alaska border. Enjoy the scenery. Watch for wildlife along the road. Overnight in Beaver Creek.

**DAY 5. BEAVER CREEK-WHITEHORSE.** Drive the Alaska Highway along beautiful Kluane Lake, Yukon's largest lake. Take a side trip into Kluane National Park, photograph snowclad peaks and glacial streams. In Whitehorse you might tour the S.S. Klondike, a retired sternwheeler. At the sod-roofed log-walled McBride Museum discover a trove of riverboat history, the stagecoach era and the Gold Rush. Overnight in Whitehorse.

**DAY 6. WHITEHORSE-SKAGWAY.** In Skagway, at the foot of White Pass, you're at the exact spot where thousands of fortune-seekers came ashore from their crowded ships, in a fever to search for gold. Tour the town and visit their haunts. Overnight Skagway.

**DAY 7. SKAGWAY, SAIL.** This morning turn in your RV. Before embarking on your cruise you be sure and pick a fun shore excursion such as **Liarsville Gold Rush Trail Camp and Salmon Bake** tour. Afterward board your Holland America Line ship, and set sail for Vancouver, B.C.

**DAYS 8-11. GLACIER BAY, KETCHIKAN PORT OF CALL, AND CRUISING THE INSIDE PASSAGE.** On a memorable day in Glacier Bay National Park, watch the birth of icebergs and experience nature at her most sublime. Then your elegant ship enters the scenic Inside Passage, including a port call at Ketchikan. Here, you may choose to select an exciting optional shore excursion like the **Rainforest Canoe & Nature Trail, Backcountry Jeep. & Canoe Safari** or the **Rainforest Island Adventure**. On day 11 disembark in Vancouver, B.C., tour's end.

**CUSTOM SELECTION 2-A: Deletes Beaver Creek and 2nd night at Denali. Adds Dawson City and Tok.** On day 2 drive to Fairbanks and overnight. On day 3 travel Fairbanks to Tok for overnight. Drive Tok to Dawson City on day 4, and Dawson City to Whitehorse on day 5. Days 6 through 11 remain unchanged. See price insert for additional cost for this Custom Selection.



# TOUR 3: NORTHERN HIGHLIGHTS

7-NIGHT GLACIER DISCOVERY CRUISE PLUS ANCHORAGE, FAIRBANKS & DENALI.

DAY	ITINERARY
1	Sail from Vancouver, BC
2	Cruise Inside Passage
3	Ketchikan, Alaska port call
4	Juneau, Alaska port call
5	Skagway, Alaska port call
6	Glacier Bay National Park
7	At sea (Gulf of Alaska)
8	Disembark in Whittier, Alaska; Transfer to Anchorage, Alaska
9-10	Anchorage to Denali National Park
11-12	Fairbanks, Alaska
13	Glennallen, Alaska
14	Anchorage, Alaska
15	Tour's End



**DAYS 1-7. GLACIER DISCOVERY CRUISE, CRUISE THE INSIDE PASSAGE.** Board your ship in Vancouver, B.C. Your cruise includes ports of call at Ketchikan, Juneau, and Skagway, plus cruising Glacier Bay National Park and the Gulf of Alaska. **Be sure and check out the variety of shore excursion options that are available to enhance your trip.**

**DAY 8. WHITTIER-ANCHORAGE.** After you disembark in Whittier, board your comfortable motorcoach or van for a scenic trip to Anchorage, where you pick up your RV. We give you a thorough orientation on your vehicle, then overnight at **Anchorage Ship Creek RV Park**. You'll have time left to sightsee and stock up on groceries, or have dinner out.

**DAY 9. ANCHORAGE-DENALI.** Drive the Glenn and Parks Highways to Denali, with mountain ranges to right and left. Watch for a glimpse of the Great One—Denali—if weather permits. Overnight near the entrance to Denali National Park for two nights.

**DAY 10. DENALI NATIONAL PARK.** Your day to explore the Park.

**DAY 11. DENALI-FAIRBANKS.** Rejoin the scenic Parks Highway, and drive north to Fairbanks, Alaska's second-largest city. Keep your camera handy, as wildlife sightings are common along the road. Fairbanks is closer to the Land of the Midnight Sun, so you'll have plenty of daylight after you arrive at your campsite. Overnight Fairbanks two nights.

**DAY 12. FAIRBANKS.** There's no lack of things to do here. Consider a visit to the University of Alaska-Fairbanks, with its excellent museum. Inspect a retired gold dredge, or view the TransAlaska Pipeline up close.

**DAY 13. FAIRBANKS-GLENNALLEN.** You start your day driving on the famous Alaska Highway. At Delta Junction, branch off southward on the Richardson Highway. You'll have many sightings of the TransAlaska Pipeline and gorgeous views of the Wrangell Mountains in Wrangell-St. Elias National Park. Overnight near Glennallen.

**DAY 14. GLENNALLEN-ANCHORAGE.** Glennallen is the gateway to Alaska's Copper River region, famous for its wild salmon runs. As you drive southwest on the Glenn Highway, you'll enjoy more magnificent mountain views. Overnight at your reserved campsite at **Anchorage Ship Creek RV Park**.



**DAY 15. ANCHORAGE, TOUR'S END.** This morning bid your trusty vehicle au revoir, then we transfer you to the airport for your flight home.

**CUSTOM SELECTION 3-R: RV Land Tour First, Followed by a Cruise.** On day 1 pick up RV in Anchorage. Days 1 through 8 on land are same as 8 through 15 on Highway Cruise 3. On Day 8 drop off RV in Anchorage, transfer to Whittier and sail to Vancouver, B. C.

**CUSTOM SELECTION 3-K: Deletes Fairbanks. Adds the Denali Highway and Kenai Peninsula.** On day 11 drive from Denali to Glennallen. Travel from Glennallen to Cooper Landing on day 12 and Cooper Landing to Homer on day 13. Return to Anchorage on day 14 and overnight. Day 15 remains unchanged. *See price insert for additional cost for this Custom Selection.*

**CUSTOM SELECTION 3-KR: RV Land Tour First, Followed by a Cruise.** Tour begins in Anchorage. Drive to Cooper Landing on day 1 and Homer on day 2. Overnight on day 3 in Anchorage and drive to Denali on day 4 for two nights. Drive the Denali Highway on day 6, overnighing near Glennallen. Day 7 return to Anchorage for final overnight on land. Turn in the RV the morning of day 8 and transfer to Whittier to set sail for Vancouver.



# TOUR 4: ALASKA HIGHWAYS ADVENTURE

7-NIGHT VANCOUVER TO WHITTIER. GLACIER DISCOVERY CRUISE PLUS ANCHORAGE, DENALI, FAIRBANKS & THE ALASKA HWY.

DAY	ITINERARY
1	Set sail from Vancouver, BC
2	Cruising the Inside Passage
3	Ketchikan, Alaska port call
4	Juneau, Alaska port call
5	Skagway, Alaska port call
6	Glacier Bay National Park
7	At sea (Gulf of Alaska)
8-9	Disembark in Whittier; Transfer to Anchorage
10-11	Denali National Park
12	Fairbanks, Alaska
13	Beaver Creek, Yukon
14-15	Whitehorse, Yukon
16	Watson Lake, Yukon
17	Fort Nelson, BC
18	Dawson Creek, BC
19	Prince George, BC
20	Cache Creek, BC
21-22	Anacortes, WA; Seattle; Tour's End



**DAYS 1-7. GLACIER DISCOVERY CRUISE, INSIDE PASSAGE.** Board your cruise ship in Vancouver, B.C. Your cruise includes calls at Ketchikan, Juneau, and Skagway, plus cruising Glacier Bay National Park and the Gulf of Alaska. **Check out the variety of shore excursion available in all three ports.**

**DAY 8-9. WHITTIER-ANCHORAGE.** This morning, arrive in Whittier and board a comfortable motorcoach or van for your excursion to Anchorage and a thorough orientation on your RV. Overnight at **Anchorage Ship Creek RV Park** for the next two nights. Spend the day exploring Anchorage, Alaska's largest city. With long summer days, 120 miles of paved bicycle trails and breathtaking scenery, cycling is a wonderful way to explore Anchorage or go for a drive along Turnagain Arm. If conditions permit, you may witness the tidal bore—a wall of water rushing up the inlet.

**DAY 10. ANCHORAGE-DENALI.** Drive the Glenn and Parks Highways to Denali, with mountain ranges to right and left. Overnight near the entrance to Denali National Park next two nights.

**DAY 11. DENALI NATIONAL PARK.** There are many optional tours at the Park to choose from, sign up for the optional 13-hour scenic wilderness tour. Watch for the abundant wild creatures and, weather permitting, that most elusive wild wonder of all, Denali.

**DAY 12. DENALI-FAIRBANKS.** On the road again, head for Fairbanks, where the sun hardly sets at all in summertime. In late summer you might see the aurora borealis. You may want to visit the University of Alaska-Fairbanks, with its excellent museum and demonstration gardens, or inspect a retired gold dredge and try gold panning. Overnight in Fairbanks.

**DAY 13. FAIRBANKS-BEAVER CREEK.** Head out on the Alaska Highway to Beaver Creek, near the Yukon-Alaska border. Enjoy the scenery. Watch for wildlife along the road, and the TransAlaska Pipeline, snaking its way over hills and valleys. Overnight in Beaver Creek.

**DAY 14-15. BEAVER CREEK-WHITEHORSE.** Drive the Alaska Highway along beautiful Kluane Lake, Yukon's largest lake. In Whitehorse you might tour the S.S. Klondike, a retired sternwheeler. At the sod-roofed McBride Museum, discover a trove of Gold Rush history. Overnight in Whitehorse. Next day, free day to explore Whitehorse. Overnight.

**DAY 16. WHITEHORSE-WATSON LAKE.** On the way to Watson Lake, make sure to see the Sign Forest, a thicket of more than 10,000 highway signs—still growing. Overnight at Watson Lake, gateway to the Yukon.

**DAY 17. WATSON LAKE-FORT NELSON.** Watch for caribou and Stone sheep along the highway—and, of course, sensational mountain views. Overnight in Fort Nelson.

**DAY 18. FORT NELSON-DAWSON CREEK, B.C.** Take your leave of Fort Nelson and head off south toward Dawson Creek, Mile 0 of the Alaska Highway. Overnight Dawson Creek.

**DAY 19. DAWSON CREEK-PRINCE GEORGE.** Following Highway 97, you drive on, taking your time and stopping when you like. By evening you are in Prince George, "hub of the North." This remote city has galleries, theaters and fine dining. Overnight Prince George.

**DAY 20. PRINCE GEORGE-CACHE CREEK.** Drive along the route of the old Cariboo Wagon Road to Cache Creek, once a major supply point for the goldfields. Good side trips: fantastic rock formations called "hoodoos" at Pinnacle Provincial Park; and Barkerville, a reconstructed gold rush town. Overnight in Cache Creek.

**DAY 21-22. CACHE CREEK-ANACORTES, WA & TOURS END.** From Cache Creek, head south into Anacortes. Check out the Anacortes Museum which contains Fidalgo and Guemes Island artifacts. Overnight in Anacortes. Early morning on your last day, depart for the Seattle RV Depot where you will bid farewell and transfer to Seattle-Tacoma International Airport for your flight home.

**CUSTOM SELECTION 4R: RV Land Tour First, then Cruise Afterward.** Similar to Highway Cruise 4 in reverse except as noted. On day 1 transfer from Seattle-Tacoma International Airport to pick up your RV; RV orientation then overnight in Anacortes, WA. Days 2 through 14 of Highway Cruise 4-R are the reverse of days 9 through 21 of Highway Cruise 4. On day 15 return the RV, transfer to Whittier and cruise for 7 nights to Vancouver, B.C.

**CUSTOM SELECTION 4E: Extends Highway Cruise 4 to 28-nights/29-days by Adding the Kenai Peninsula and Extra Nights in Several Other Locations.** Adds 2-nights in Homer (days 10 & 11), a night at Cooper Landing (day 12), one night in Whittier (day 13) and an extra night each in Anchorage (day 14), Fairbanks (days 17 & 18), and Whitehorse (days 20, 21 & 22).

**CUSTOM SELECTION 4ER: Extends Highway Cruise 4-R to 28-nights/29-days by Adding Extra Nights in Several Locations and includes the Kenai Peninsula.** On day 1 transfer from Seattle-Tacoma International Airport to pick up your RV; RV orientation then drive to Anacortes for overnight. Days 2 through 21 of Highway Cruise 4-ER are the reverse of days 9 through 28 of Highway Cruise 4. On day 22 turn in the RV, transfer to Whittier, and cruise for 7-nights to Vancouver, B.C.



# TOUR 5: NATIONAL PARKS EXPLORER

7-NIGHT CRUISE FEATURING THE NATIONAL PARKS OF ALASKA & CANADA'S YUKON

DAY	ITINERARY
1	Set sail from Vancouver, BC
2	Cruising the Inside Passage
3	Ketchikan, Alaska port call
4	Juneau, Alaska port call
5	Skagway, Alaska port call
6	Glacier Bay National Park
7	At sea (Gulf of Alaska)
8	Disembark in Whittier; Transfer to Anchorage
9-10	Denali National Park
11-12	Fairbanks, Alaska
13	Tok, Alaska
14-15	Dawson City, Yukon
16-17	Whitehorse, Yukon
18	Kluane National Park, Yukon
19	Beaver Creek, Yukon
20	Glennallen, Alaska
21-22	Anchorage, Alaska; Tour's End



**DAYS 1-7. GLACIER DISCOVERY CRUISE, CRUISE THE INSIDE PASSAGE.** Board your ship in Vancouver, B.C. Your cruise calls at the ports of Ketchikan, Juneau, and Skagway plus cruising Glacier Bay National Park and the Gulf of Alaska. **Check out the variety of shore excursion available in all three ports.**

**DAY 8. WHITTIER-ANCHORAGE.** Disembark at Whittier and enjoy a scenic ride to Anchorage to pick up your RV. After your orientation, you have time to see a museum, dine on seafood, or stock up on groceries. Overnight at **Anchorage Ship Creek RV Park.**

**DAY 9. ANCHORAGE-DENALI.** Drive the scenic Parks Highway to Denali National Park where you will overnight near the park entrance for two nights.

**DAY 10. DENALI NATIONAL PARK.** A free day to explore the home of North America's tallest mountain: 20,320-ft. Denali.

**DAY 11. DENALI-FAIRBANKS.** On the road again, head for Fairbanks, nearer the Land of the Midnight Sun, with plenty of daylight for recreation. Overnight in Fairbanks.

**DAY 12-13. FAIRBANKS-TOK.** Free day to explore Fairbanks; overnight. Ride the historic Alaska Highway to Tok, self-proclaimed "dog-mushing capital of the world." See the TransAlaska Pipeline. Overnight in Tok.

**DAY 14. TOK-DAWSON CITY.** The scenery is other-worldly on the Taylor and Top-of-the-World Highways before you descend to the banks of the Yukon River and cross by ferry to Dawson City. Overnight in Dawson City.

**DAY 15-17. DAWSON CITY-WHITEHORSE.** You have a free day to wander the wooden sidewalks of this perfectly preserved gold rush town. Visit the S.S. Keno sternwheeler, a National Historic Site. Then drive the Klondike Highway to Whitehorse. Overnight Whitehorse for two nights. Free day to explore Whitehorse, capital of the Yukon Territory.

**DAY 18. WHITEHORSE-KLUANE NATIONAL PARK.** Overnight near Kluane National Park.

**DAY 19. KLUANE NATIONAL PARK-BEAVER CREEK.** Drive the famous Alaska Highway and watch for views of blue, glacier-fed Kluane Lake in Kluane National Park. Overnight in Beaver Creek.

**DAY 20. BEAVER CREEK-GLENNALLEN.** On to Tok, then head to Glennallen via Alaska, Richardson and Glenn Highways. Enjoy the views of the majestic Wrangell Mountains in Wrangell-St. Elias National Park enroute. Optional side trip to the Wrangell-St. Elias National Park and Preserve Visitor Center. Overnight near Glennallen.

**DAY 21. GLENNALLEN-ANCHORAGE.** More gorgeous scenery today, maybe viewing Dall sheep on the way to Anchorage. Overnight at **Anchorage Ship Creek RV Park.**

**DAY 22. ANCHORAGE, TOUR'S END.** Turn in your RV; we'll provide the transfer to the airport.

**CUSTOM SELECTION 5-R: Reverse Itinerary. Land Tour First, Cruise Afterwards.** On day 1 transfer from Anchorage International Airport or local hotel to pick up your RV; RV orientation and overnight in Anchorage. Days 2 through 14 of land tour are the same as days 9 through 21 of Highway Cruise 5. On day 15, turn in your RV, transfer to Whittier to board your ship and sail to Vancouver.







## THE ULTIMATE ROAD ADVENTURE!

There's no better way to experience the interior marvels of the Great Land than from the vantage point of one of **Alaska Motorhome Rental's** roomy, comfortable motorhomes. See the sights up close, stop to snap a photo, go fishing, have a picnic. Best of all, you set your own pace, choose where you're going to go, and how long you want to stay. *Freedom has never felt so good!*

### HERE ARE A FEW OF THE HIGHLIGHTS ALONG THE ROAD:

**Anchorage**, may be Alaska's largest city, but you still sense the proximity of the wilderness and the frontier spirit. Witness the tidal bore along Turnagain Arm (conditions permitting), when a wall of water up to six feet high rushes up the inlet. Catch a comfortable night's rest at **Anchorage Ship Creek RV Park**.

**Homer, on the Kenai Peninsula**, attracts fishermen, artists and seekers of spectacular scenery. Across the bay a timbered coastline rises to the glacier-capped peaks of the Kenai Mountains. Visit Homer Spit, a small-boat harbor, canneries, boat building shops and the occasional artist with an easel.

**Denali National Park and Preserve** is home to North America's tallest mountain, and to wildlife in amazing abundance. Weather permitting, you may catch a glimpse of 20,320-ft. Denali long before you reach the park, from the highway between Anchorage and Fairbanks.

**Fairbanks** began as a Gold Rush town and has been thriving ever since. Here you may inspect the TransAlaska Pipeline just outside of town, visit Gold Dredge #8, and try your hand at panning.

**Skagway** was one of the liveliest towns in the hemisphere in 1898, when it was the gateway to Gold Rush Country. And it hasn't lost a particle of its spirit. The whole downtown is a National Historic Park, with its well-trodden boardwalks and false-fronted saloons. Shopping is fun here, for anything from gold nugget jewelry to original works of Alaskan art.

**The Alaska Highway.** This historic road began as a one-lane supply line to Alaska at the outbreak of World War II. Today it runs from Dawson Creek, BC, for 1,486 miles to Fairbanks. Along the way you might spot moose, caribou, bison and Dall sheep.

**Kluane National Park and Preserve**, between Whitehorse and Beaver Creek, is an UNESCO World Heritage Site. It contains some of Canada's highest peaks and is a prime wildlife-viewing area. The Alaska Highway skirts crystal-clear, glacier-fed Kluane Lake for 40 miles while the snow clad, 7,000-ft.-plus Kluane Ranges parallel the highway to the west. You may glimpse distant giants of the St. Elias Mountain Range.

**The Yukon.** Whitehorse, capital of Yukon Territory, is a friendly modern city that provides vivid reminders of its Gold Rush beginnings. You may visit the grand old sternwheeler, S.S. Klondike, permanently anchored on dry land by the riverside.

**Dawson City** is a perfectly preserved Gold Rush town. Hardly anything has changed since the boom days when thousands descended on the town to get rich quick.



### WHY CHOOSE US?

#### EXPERIENCE.

We have been providing Alaska visitors quality vacation experiences since 1978.

#### MODERN FLEET.

We boast the newest fleet of motorhomes in Alaska.

#### SAVINGS.

We offer a host of discounts: Military Discount, AAA, AARP, and Extended Rental Discounts, and Web Specials throughout the season.

#### AIRPORT TO RV DIRECT SERVICE.

Alaska Motorhome Rentals offers an optional transfer service that will pick you up curbside and take you directly to your assigned motorhome, then promptly conduct your orientation and get you on your way.

#### ONE-WAY RENTALS.

With Alaska Motorhome Rentals you can cruise from Vancouver to Anchorage then drive the Alaska Highway south to Seattle.

Visit [AlaskaTravelAdventures.com](http://AlaskaTravelAdventures.com) for interior RV photos, reviews and more!



## FREQUENT QUESTIONS:

**If you've never driven a motorhome before, no problem!** All of our motorhomes are Class C "cabovers", simply a home built on a van chassis—our guests tell us it's as easy as driving a car. Here are answers to some common questions to help you become more comfortable with your home on wheels.

**What's the driver's cab like?** You have a tilt wheel, two captain's chairs with arm rests, power steering, automatic transmission, ABS power brakes and cruise control. The turning radius is remarkably short so driving will be easy, comfortable and safe. The cab has backup camera, AC, AM/FM stereo and CD player.

**How about the living area?** All our RVs have a shower, bathroom, full galley, dinette, storage areas, and comfortable beds. They have roof air conditioning and a furnace with automatic thermostat control, water heater, range with oven and/or a microwave oven and a large refrigerator/freezer. All the comforts of home!

**Will my RV be hard to drive?** No—it will be similar to driving a van or a pick-up. For most of our guests, this is a first experience with an RV, and they give us high ratings for "ease of driving."

**I haven't driven an RV before. Will you teach me what to do?** Yes; every guest is given a very thorough orientation on operation of the RV before setting out. You'll be able to reach us at our toll-free Roadside Assistance number if you have further questions.

**What will my RV be like? How big and what layout?** Our fleet of Class C motorhomes are late-model, with 5-speed automatic overdrive transmission. Depending on the size of your party, your preferences and vehicle availability, it will be between 21 and 32 feet long, and will sleep 2 to 6 people. The larger models provide plenty of room and privacy for families and other guests.

**How is the driving in Alaska?** Much like driving any two lane rural highway in the "Lower 48". There's less traffic, but may have more road construction. Roads are sometimes bumpier, due to permafrost typical for Alaska and the Yukon.

**What if I need assistance?** You're not alone out there. You may call our special toll-free number, 16 hours a day, 7 days a week for Roadside Assistance. We'll help you solve the problem, or get you to someone who can.

**How about housekeeping supplies & equipment?** With our optional housekeeping package, just about everything you need is supplied; towels for bath and kitchen, sheets, blankets and pillows. The kitchen is stocked with pots, pans, utensils, glassware, flatware, electric toaster and coffeemaker.



## YOUR HOME ON THE ROAD

**See Alaska at your own pace.** We offer Standard and Large Class C cabover size options, so no matter what your needs are we have an RV to fit you.

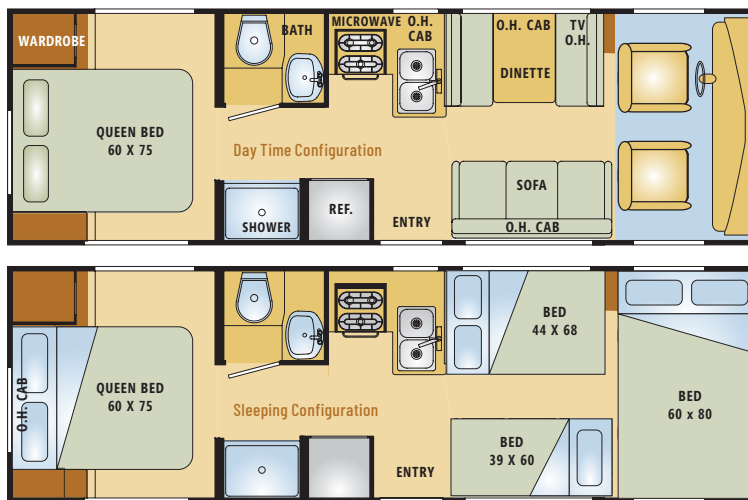

**LARGE RV** Perfect for a party of 4 to 6 (28-31 feet)

*Motorhome sizes are determined by exterior length. The floor plan illustrations shown here are samples of the day and night configurations. The actual floor plan in your vehicle may be different from those illustrated.*



**STANDARD RV** Perfect for a party of 2 to 4 (21-24 feet)

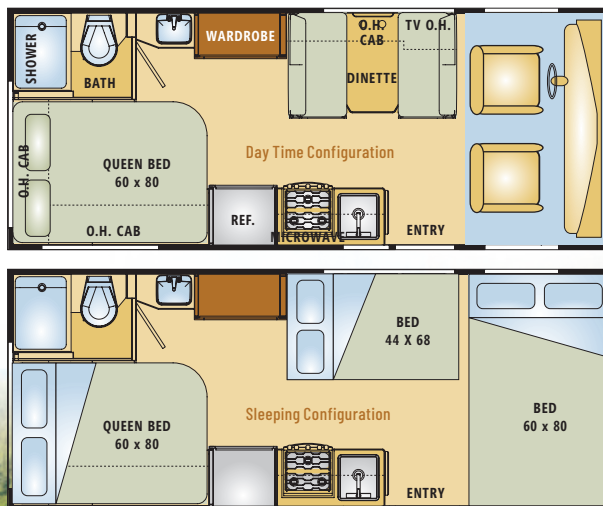





# THE MOST TOURS & ATTRACTIONS IN ALASKA

All of our trips feature personalized attention and provide you with a chance to experience Alaska's natural splendor—we offer exciting tours that will fit right into your Alaska vacation, no experience necessary. Alaska Travel Adventures is an equal opportunity provider. Visit [AlaskaTravelAdventures.com](http://AlaskaTravelAdventures.com) for tour descriptions, photos, videos and more!  indicates tours that operate in the Tongass National Forest under a permit issued by the USDA Forest Service.

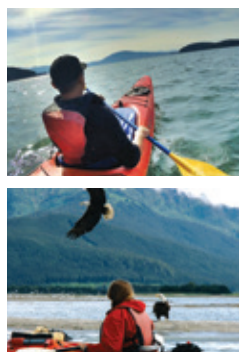

## GLACIER VIEW SEA KAYAKING

JUNEAU | 3-1/2 HRS.

Glide through the waters native-style, get an up-close look at wildlife, and enjoy ever-changing views of the Mendenhall Glacier after a narrated tour through a historic part of Juneau on your way to North Douglas Island. Your guide will teach you paddling techniques and provide an interpretive narrative while you kayak against a backdrop of forested slopes, nearby peaks and the spectacular Mendenhall Glacier. Along the way, your guide will inform you about local flora, fauna and landmarks. Stealthily approach wildlife—bald eagles, herons, shorebirds and waterfowl are all common sights. Porpoises and even humpback whales occasionally surface for air. If you're lucky, you might see a humpback's enormous tail fluke. Includes an Alaskan-style snack.



## GOLD MINING & PANNING ADVENTURE

JUNEAU | 1-1/2 HRS.

Catch "gold fever" and experience what it was like to seek your fortune during Gold Rush days! Learn to pan for gold, and discover Juneau's colorful mining heritage. Head out with a prospector/guide for a historical tour of Juneau then head for Gold Creek and "Last Chance Basin". Your prospector will show you how gold panning is done creek side, in a beautiful, secluded mountain setting. We are the only company allowed to use this special place, and you may witness some real panners. You will expertly work the pan with helpful tips, and you will find gold—guaranteed! Take home a souvenir Orelove Brothers Gold Claim Certificate and all the gold you find! **Combine with:** *Gold Creek Salmon Bake (3 hrs.)*



## GOLD CREEK SALMON BAKE

JUNEAU | 1-1/2 TO 2 HRS.

Featured on *Bravo Television's Top Chef*, Gold Creek Salmon Bake is an event that's been grilled to perfection since 1978. This sumptuous all-you-can-eat feast features our signature alderwood-grilled WILD Alaska salmon, Cheechako chicken, Chilkoot baked beans, Tongass wild-rice pilaf, hot chowder, a selection of sides, salads, beverages and homemade blueberry cake for dessert. Beer and wine are available for purchase. Take a short stroll to beautiful Salmon Creek Falls where you can pan for gold, see mining relics, and look for salmon. Have fun roasting marshmallows over a campfire and taking photos at our interactive, gold rush mural. **Combine with:** *Gold Mining & Panning (3 hrs.);  Lake Kayaking (5 hrs.); Whale Watching (5 hrs.)*



## MENDENHALL GLACIER FLOAT TRIP

JUNEAU | 3-1/2 HRS.

Board your raft at the iceberg-studded lake of the spectacular Mendenhall Glacier, and marvel at the views of towering mountains, forests and wildlife as the river carries you from the half-mile-wide glacier face, in the Tongass National Forest, through the glacial-carved Mendenhall Valley. You'll have the option to paddle the raft while being entertained by your professional guide's interpretive narrative, but most of our guests choose to have the guide do all the work—sit back, relax and smile for the photographer during the short stretch of class II and III rapids. Be on the lookout for bald eagles, black bears, otters, and deer. Includes an Alaskan-style snack and beverages.



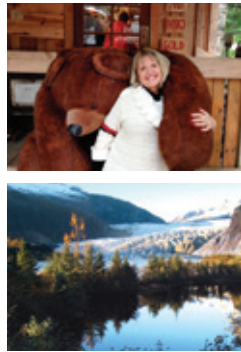

## MENDENHALL GLACIER & SALMON BAKE

**JUNEAU | 3-1/2 HRS.**

Your driver-guide recounts the history of Juneau's gold rush en route to monumental Mendenhall Glacier. This meandering river of compressed blue ice ranks as the largest glacier accessible by road in southeast Alaska. It runs a half-mile wide, hundreds of feet deep and is fed by the 1,500-square-mile Juneau Icefield. The USFS staff offers information on glaciers and the Mendenhall Glacier Visitor Center features exhibits, interactive videos and a panoramic view of the glacier. Don't forget your camera! Explore the numerous self-guided walking trails to experience the special beauty of Tongass National Forest and ever-changing glimpses of the glacier. Then head for the all you can eat Gold Creek Salmon Bake!



## MENDENHALL LAKE KAYAKING ADVENTURE

**JUNEAU | 3-1/2 HRS.**

Be one of the lucky few to kayak near the face of the majestic Mendenhall Glacier. Your guide will teach you kayaking techniques, then board the two-person kayaks, with either a new friend or traveling companion. Journey across Mendenhall Lake in your stable kayak, navigating the iceberg studded pristine water that is truly one of the jewels of the Tongass National Forest. Your guide will explain the breathtaking nature surrounding you and the history and ecology of Mendenhall Glacier. Venture within a safe distance of the massive, awe-inspiring face of the glacier and skirt the base of the beautiful and powerful Nugget Falls. After paddling back across the lake, enjoy an Alaskan-style snack.

**Combine with:** [Salmon Bake \(5 hrs.\)](#)



## MENDENHALL LAKE CANOE ADVENTURE

**JUNEAU | 3-1/2 HRS.**

Be among the select few, under a limited USFS permit, to travel by canoe for an unprecedented experience near the face of the majestic Mendenhall Glacier. Paddle across Mendenhall Lake in a traditional Native-style canoe—an exceptionally stable 28-foot watercraft—navigating past icebergs, surrounded by one of the richest samplings of Alaskan wildlife you'll find anywhere. Birds, including Arctic terns, nest on the shoreline and eagles, goats, salmon and bears can all be seen. Then, venture within a safe distance of the massive, awe-inspiring face of the living Mendenhall Glacier. Grab a thrill ride by skirting the base of beautiful and powerful Nugget Falls. Then refuel with a snack of Alaskan-style fare for the return.

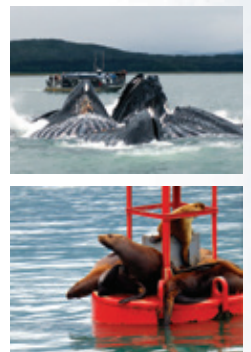

## WHALE WATCHING ADVENTURE

**JUNEAU | 3-3/4 HRS.**

Your whale watching adventure begins with a narrated transfer from the pier to Auke Bay. There your captain and onboard naturalist will welcome you aboard our state of the art 48-passenger jet boat custom designed for Juneau whale watching with large windows and an outside viewing deck. Enjoy a beautiful view of the Mendenhall Glacier as you travel in and out of Fisherman's Bend. Provided binoculars may enhance your view of whales as well as sea lions, seals and porpoises. Whale sightings are guaranteed!

**Combine our Whale Watching Adventure with:** [Salmon Bake \(5hrs.\)](#); or [Best of Juneau® adds Salmon Bake and !\[\]\(23a2e9ddc7bb0ef55393d38b772a848d\_img.jpg\) Mendenhall Glacier \(6.25 hrs.\)](#)



# SEE MORE OF ALASKA!



## BACKCOUNTRY JEEP® & CANOE SAFARI KETCHIKAN | 4 HRS.

Fill your senses with adventure and excitement as you take control of an automatic 4-WD Jeep Wrangler® and wend your way through the rugged back roads of Revillagigedo Island and paddle across a serene mountain lake in a 37-foot, 20-passenger Native-style canoe. You'll travel mountainous unmaintained logging roads in the Tongass National Forest and enjoy informative narration via your interactive radio, with photo stops along the way. Upon your arrival at Lake Harriet Hunt, you'll experience a unique ecosystem from the vantage point of a large, easy to paddle, guided canoe and nature walk through an old-growth forest. Our cook will have your hot Alaskan-style snack prepared for you at a remote camp along the shore.



## RAINFOREST CANOE ADVENTURE & NATURE TRAIL KETCHIKAN | 3-1/2 HRS.

A scenic motorcoach tour will lead you to a secluded mountain lake, surrounded by the Tongass National Forest. Lake Harriet Hunt, part of lush rainforest, is ideal for canoeing. Your Alaska Native-style, 37-foot, 20 passenger canoes are fast, stable, and easy to maneuver. An experienced guide will interpret the unique natural and Alaska Native history of the Ketchikan area while you scan for wildlife. Step ashore for a hearty Alaskan-style snack and beverages at a remote camp where your guide will lead you on a short nature walk highlighting flora and fauna of the rainforest. This adventure is a rare opportunity to comfortably explore Southeast Alaska in the manner of its original explorers and early culture.



## RAINFOREST ISLAND ADVENTURE KETCHIKAN | 4 HRS.

A motorized rigid hull inflatable Seahawk provides a short, but exciting cruise along the coast of Clover Passage where whales, sea lions, seals, porpoise, bald eagles and migrating seabirds may be spotted. Join your knowledgeable naturalist guide on a secluded beach in the Tongass National Forest, for a walk through natural, unspoiled beauty in the coastal rainforest on Betton Island. Hike through the beautiful old growth forest, and learn about botanic species native to this region. Enjoy an Alaskan-style snack at a campfire and take some time to explore tide pools or other interesting elements of the natural beauty around you before reboarding the Seahawk for the return trip to Knudson Cove.

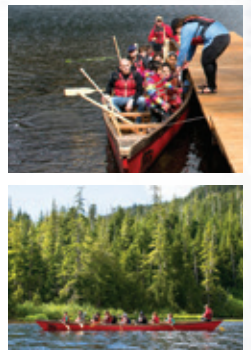

## TOTEM BIGHT STATE HISTORICAL PARK & RAINFOREST CANOE ADVENTURE KETCHIKAN | 4 HRS.

Alaska Native art and traditions are highlighted in this perfect combination of history and adventure. Explore historical artifacts, the Tongass Narrows and the colorful Clan House at Totem Bight State Historical Park, an 11-acre park featuring ancient totem poles set in a lush rainforest, before heading to Lake Harriet Hunt for your experience in Native-style canoes on a pristine mountain lake. Your guide will lead you to a secluded cook camp, where your cook will be preparing an Alaska-style snack for you. From the camp, your guide will interpret the features of a temperate rainforest on a nature walk through old-growth forest.





## WILDERNESS SEA KAYAKING SITKA | 3 HRS.

Climb aboard our fast, custom-built inflatable vessel for an exciting sight-seeing tour en route to our floating base camp. Your knowledgeable captain will identify points of interest and scan for wildlife. At our float house, gear up while being instructed in the use of two-person kayaks and paddling technique. Traveling these waters by kayak allows you to enjoy the beauty of the protected bays and inlets near Sitka in a fun and active way. Your experienced guide will point out unique sights, explain colorful intertidal invertebrates and the ecosystem of the rainforest surrounding you while you glide silently through breathtaking scenery. Keep an eye out for swooping eagles, brown bears, whales, harbor seals or Sitka black-tailed deer.



## SKAGWAY SALMON BAKE AT LIARSVILLE SKAGWAY | 1-1/2 HRS.

An all you can eat mouth-watering assortment of warm and cold dishes awaits your arrival in Skagway. This sumptuous all you can eat feast features our signature alderwood-grilled WILD Alaska salmon, Cheechako chicken, Chilkoot baked beans, Tongass wild-rice pilaf, a selection of sides, salads, beverages and homemade blueberry cake for dessert. Beer and wine are available for purchase. This delicious meal also includes a visit to an 1898 replica campsite located in the historic Liarsville region. Converse with our colorful characters and gold-digging madams as you enjoy a glimpse back at life during the Klondike gold rush. Visit the Fancy Goods Gift Shop to find that special souvenir.



## LIARSVILLE GOLD RUSH TRAIL CAMP & SALMON BAKE SKAGWAY | 2 HRS.

Discover Liarsville Gold Rush Trail Camp and Salmon Bake at the foot of the White Pass, nestled beside a waterfall. This sumptuous all you can eat feast features our signature alderwood-grilled WILD Alaska salmon, Cheechako chicken, Chilkoot baked beans, Tongass wild-rice pilaf, a selection of sides, salads, beverages and homemade blueberry cake for desert. Beer and wine are available for purchase. Enjoy the waterfall and the authentic exhibits of Liarsville Gold Rush Trail Camp. A cast of sourdoughs and dance hall girls will entertain you with a hilarious Robert Service melodrama before your prospector teaches you the art of gold panning, then be set free in the Liarsville gold fields, where you are guaranteed to find gold and keep all you find!







## CLOSE TO WHERE YOU WANT TO BE!

When you're ready to make your dream of visiting Alaska come true, make our Best of Alaska RV Park a part of your Alaska dream vacation. With a recreational vehicle park located in Anchorage—we offer convenience, quality service and easy access to the activities and attractions you came to see. Visit our tour desk for a host of exciting tour options.

**Anchorage Ship Creek RV Park** puts a variety of activities and amusements at your doorstep. Located just a few blocks from downtown Anchorage, it offers easy access to Alaska's largest city. In addition to being near Alaska's top attractions, there are a host of conveniences and amenities. You can be assured of clean restrooms and showers, friendly and courteous staff, full hook-ups, pull-thru sites, a local tour reservation center and more.

### ANCHORAGE SHIP CREEK RV PARK—WHERE ACTIVITIES & AMUSEMENTS ARE AT YOUR DOORSTEP.

- Near Tony Knowles Coastal Trail • Close to Downtown shopping • A few blocks to Dining & Entertainment • Walking distance to world class fishing • Bicycle rentals
- Bike & carrier rental packages • 120 miles of paved bicycle trails in Anchorage

### ANCHORAGE SHIP CREEK RV PARK AMENITIES:

- Full hook-ups & Pull Thru sites • Pet Friendly • Gift Shop • WiFi • Showers
- Laundry • Dry Sites & Tent Sites • Group & caravan rates available



VISA, MASTERCARD, AMERICAN EXPRESS & DISCOVER CARDS WELCOME  
CALL FOR GROUP & EXTENDED STAY RATES AT 1-800-323-5757  
Cancellation policy and campground rules available online.

**Alaska Travel Adventures, Inc. is proud to be a member of:**

Alaska Travel Industry Association, Anchorage Convention & Visitors Bureau,  
Alaska Campground Owners Association, Fairbanks Convention & Visitors Bureau,  
Ketchikan Visitors Bureau, Juneau Convention & Visitors Bureau,  
Skagway Visitors Bureau, and Tok Visitors Bureau.

## ANCHORAGE IS ALASKA'S LARGEST CITY

but you still sense the proximity of the wilderness and the frontier spirit. Among the sights: the world's largest seaplane base, and the Museum of History and Art. Witness the tidal bore along Turnagain Arm (conditions permitting), when a wall of water up to six feet high rushes up the inlet.







18384 Redmond Way  
Redmond, WA 98052  
1-800-323-5757

[AlaskaTravelAdventures.com](http://AlaskaTravelAdventures.com)



## COMBINED RV AND CRUISE VACATIONS!

Every **Alaska Highway Cruises** vacation includes a luxury cruise with Holland America Line along with an up-close and personal experience in your own motorhome. Your cruise itinerary options include the scenic Inside Passage.

## YOUR HOME ON THE ROAD!

**Alaska Motorhome Rentals** boasts the newest fleet of motorhomes in Alaska and has been providing Alaska visitors with quality vacation experiences since 1978. One-way rentals available, and we offer a host of discounts.

## DOZENS OF TOURS & ATTRACTIONS!

**Alaska Travel Adventures Tours & Attractions** operates more adventure tours in Alaska than any other company. From our Salmon Bake to Whale Watching to our Mendenhall Glacier Float Trip—you'll experience Alaska's natural splendor.

**Don't just visit Alaska, *experience it!***

**ANNUAL BROCHURE | [AlaskaTravelAdventures.com](http://AlaskaTravelAdventures.com) | 1-800-323-5757**

California seller of travel registration number: 2022850-40. Registration as a seller of travel does not constitute approval by the State of California.